



# BP series

## Battery Protector

BP2470N15/BP4860N25/  
BP4885N25/BP48100N25



### For off-grid application

- Can be connected to the controller to protect the battery
- Charge protector and discharge protector are configurable

### User-Friendly

- 1 digit 7-segment display for parameter
- Can be applied to co-negative system

### Reliable

- Supports the system voltage setting
- Supports over-voltage and over-discharge protection level

### Intelligent

- Supports mobile APP monitoring via Bluetooth
- Supports TTL communication

| MODEL                       | BP2470N15         | BP4860N25      | BP4885N25     | BP48100N25    | Can Be Set |
|-----------------------------|-------------------|----------------|---------------|---------------|------------|
| <b>BATTERY</b>              |                   |                |               |               |            |
| Rated Battery Voltage       | 12/24Vdc          | 12/24/36/48Vdc |               |               |            |
| Operating Voltage Range     | 8V~35V            | 8V~70V         |               |               | ✓          |
| System Withstand Voltage    | 150V              | 250V           |               |               |            |
| Rated Current               | 70A               | 60A            | 85A           | 100A          |            |
| <b>COMMUNICATION</b>        |                   |                |               |               |            |
| Standard                    | TTL communication |                |               |               |            |
| Optional                    | Bluetooth         |                |               |               |            |
| <b>GENERAL</b>              |                   |                |               |               |            |
| Weight                      | 850g              | 700g           | 950g          | 1050g         |            |
| Dimensions                  | 149*96.5*60mm     | 123*96.5*60mm  | 166*96.5*60mm | 183*96.5*60mm |            |
| Protection Degree           | IP65              |                |               |               |            |
| Operating Temperature Range | -35°C ~ 65°C      |                |               |               |            |
| Cooling mode                | Natural cooling   |                |               |               |            |
| <b>CERTIFICATION</b>        |                   |                |               |               |            |
| RoHS                        | Yes               |                |               |               |            |

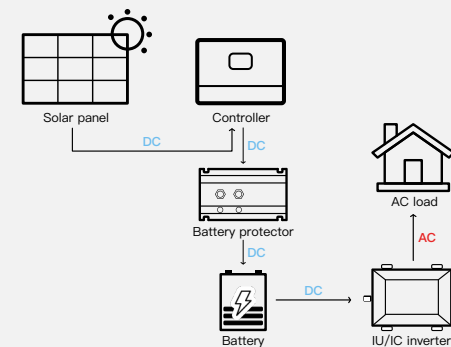

Wiring diagram